

# SITE SCALE

## Hospital Site

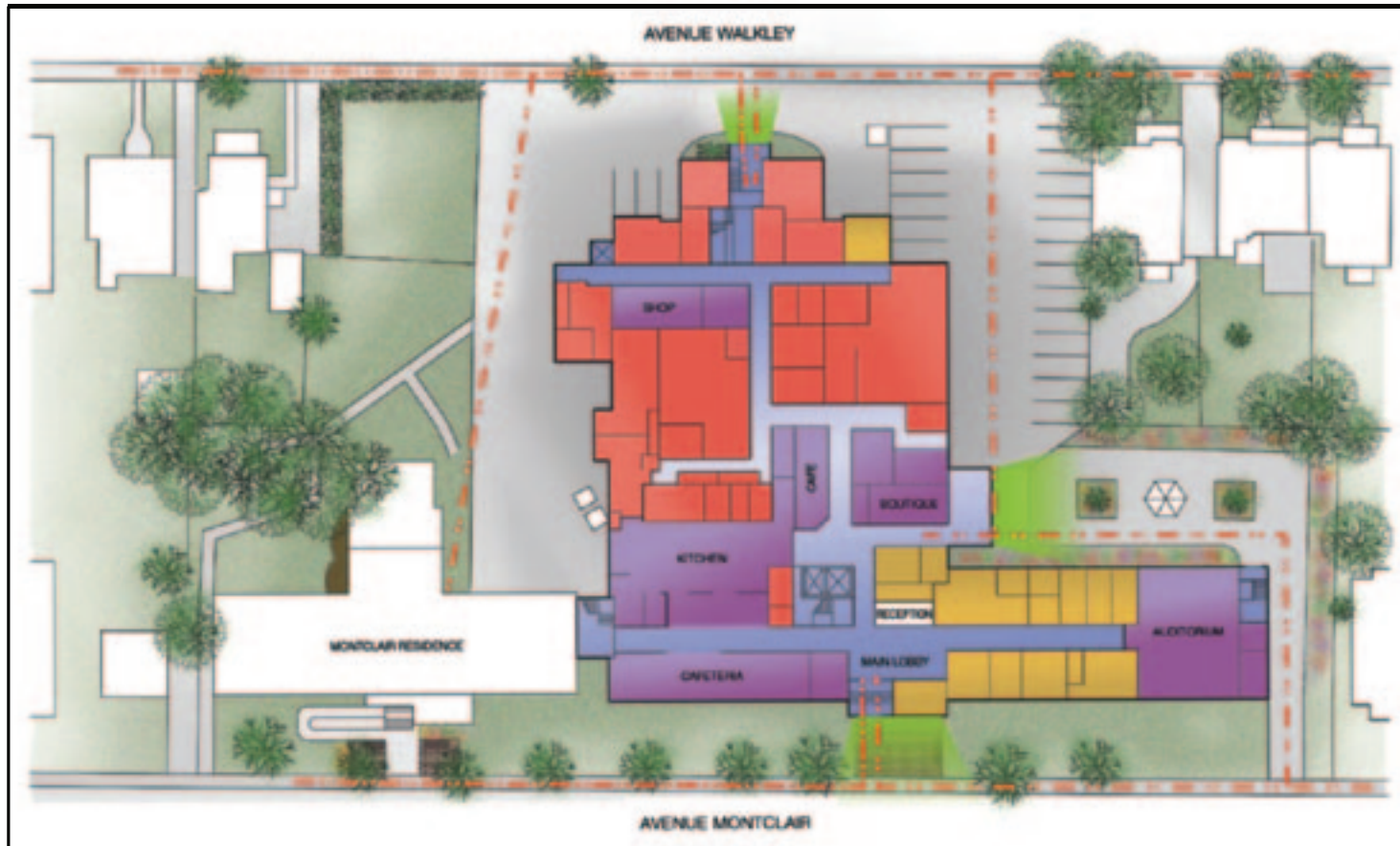

### Soft/Hard Surfaces

- Deciduous Tree
- Shrubs
- Grass
- Flowers
- Pavement
- Masonry

### Interior Program

- Circulation
- Care Rooms
- Offices
- Common
- Mechanical/Storage

### Exterior Circulation

- Exit/Entrance
- Foot Traffic Paths

## GROUND FLOOR PLAN

15m

The ground floor has been organized in such a way that the older (Walkley) side of the building has been relegated to mainly mechanical/storage space, and the newer (Montclair) side contains the common spaces (cafe, cafeteria, lobby, reception, offices). There is a garden courtyard located near the side entrance, which was previously an ambulance entrance. On the Walkley side, there are three zones with different roles. One is the service entrance (also containing the mechanical/utility/ventilation equipment), and the other functions both as the path to the side entrance as well as a parking area. Thorough analysis of a space requires the experience of moving through that space. The awareness gained by this practice provides a unique exposure to the atmosphere of a building which cannot always be captured or conveyed through the use traditional recording devices, such as a notepad or camera.

Upon entering the reception/lobby area from Montclair Ave. there is an expectation that one is about to enter into a hub of activity and movement, which is typical of modern medical facilities. In this case most staff and patients use the side entrance, while the "front" entrance is more commonly used by visitors to the hospital. The reception/lobby area does not look as though it plays a central role in life of the hospital today and is accordingly a very quiet zone in the hospital. Observable nodes of activity on the ground floor tend to be common areas such as the boutique, cafe, cafeteria and garden courtyard. Due to the fact that the treatment facilities are located on the first and second floors it makes sense that the entrances both lead towards the elevator (and stairs).